

Carve Classic

Polyamide carpet, known for its durability, can be used in any room. One of the most important advantages is the fact that the carpet fibers can stand up to a lot of wear and tear. This makes the use of nylon carpeting especially practical in areas where there is a lot of foot traffic since the synthetic fibers hold their shape longer than many other types of fibers. As a result, the pile of the polyamide carpeting looks new and fresh for many more years than other carpeting selections.

TECHNICAL SPECIFICATIONS

Secondary backing:	FBP
Quality code:	CFA
Manufacturing process:	Tufted
Manufacturing process (hospitality):	1/10" Cut Loop
Pile composition:	PA
Pile composition (hospitality):	PA
Fire behaviour:	Bfl-s1
EN 1307 Classification:	Cl. 23 / Cl. 32 Domestic Heavy / Commercial General

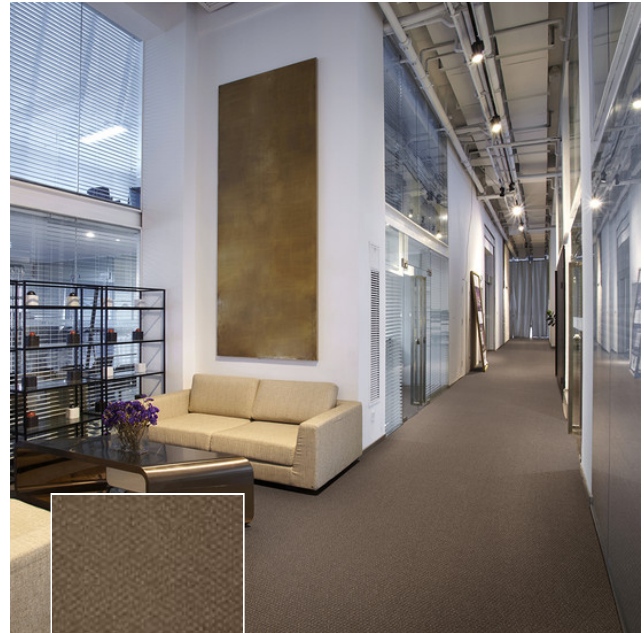

261 / Carve Classic / Camel 1

